



2009 IES ILLUMINATION AWARDS

THE EDWIN F. GUTH MEMORIAL AWARD FOR INTERIOR LIGHTING DESIGN

AWARD OF EXCELLENCE

ENTRANCE AND ATRIUM, 3 MORE LONDON RIVERSIDE

Designers: Mark Major, James Newton,
Clementine Rodgers

Company: Speirs and Major Associates
International Section



MURALE

Designers: Jesse Blonstein, Julia Vandergraaf
Company: Lightbrigade Architectural Lighting

Designer: Diego Burdi

Company: burdifilek

Owner: Shoppers Drug Mart, Inc.

Toronto Section

MUSEUM OF ISLAMIC ARTS

Designers: Paul Marantz, Hank Forrest,
Rebecca Ho-Dion, Randy Fisher

Company: Fisher Marantz Stone, Inc.
New York City Section

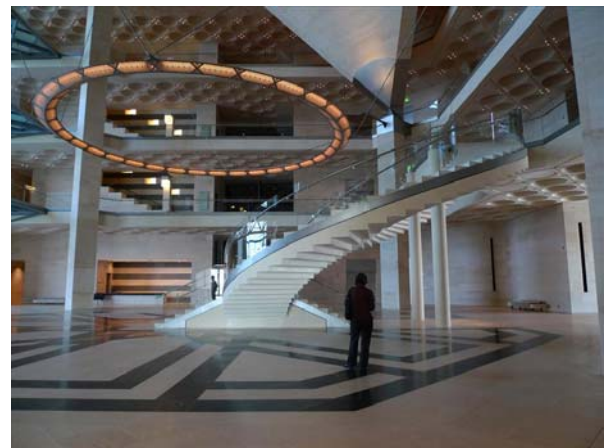

THE EDWIN F. GUTH MEMORIAL AWARD FOR INTERIOR LIGHTING DESIGN
(cont.)

AWARD OF EXCELLENCE

**NOVARTIS CAMPUS RECEPTION BUILDING AND
UNDERGROUND CAR PARK**

Designers: Alexander Rotsch, Julia Elsaesser,
Andreas Schulz

Company: Licht Kunst Licht AG

Owner: Novartis Pharma AG, Lead Management:
Ernst Basler + Partner AG
International Section



SHEIKH ZAYED BIN SULTAN AL NAHYAN MOSQUE

Designers: Jonathan Speirs, Keith Bradshaw,
Carrie Donahue Bremner, Iain Ruxton, Sarah Wisher,
Katja Nurminen, Francis Milloy, Malcolm Innes,
Sandra Downie

Company: Speirs and Major Associates
International Section

THE EDWIN F. GUTH MEMORIAL AWARD FOR INTERIOR LIGHTING DESIGN

SPECIAL CITATION



CO-CATHEDRAL OF THE SACRED HEART
For the Creative Use of Layers of Lighting in Niches
Designers: Andrew Powell, Hanna Son, Chip Israel
Company: Lighting Design Alliance
Designer: Dave Klevens
Los Angeles Section

**STAR-SPANGLED BANNER EXHIBIT,
NATIONAL MUSEUM OF AMERICAN HISTORY**
For Uniform Illumination of a Large Artifact from a Single Source

Designers: George Sexton Associates
Owner: Smithsonian Institution's National Museum of American History
District of Columbia Section



©Anice Hoachlander

THE PAUL WATERBURY AWARD FOR OUTDOOR LIGHTING DESIGN

AWARD OF EXCELLENCE

**7TH COURTYARD OF BEIJING OLYMPIC GREEN
CENTRAL DISTRICT**

Designer: Zheng JianWei
Company: bLd Lighting Design Studio, Beijing Institute
of Architectural Design (BIAD)
International Section



THE PAUL WATERBURY AWARD FOR OUTDOOR LIGHTING DESIGN

SPECIAL CITATION



PENTAGON MEMORIAL

For the Lighting of an Art Form

Designers: Keith Kaseman, Julie Beckman

Company: KBAS

Designers: Jack Mashel, Craig Newman,
Zachary Gomes

Company: Starfire Lighting, Inc.

Designer: Yukio Akashi

Company: Lighting Research Center,
Rensselaer Polytechnic Institute

Philadelphia Section

THE ENERGY AND ENVIRONMENTAL DESIGN AWARD SPONSORED BY OSRAM SYLVANIA

AWARD OF EXCELLENCE

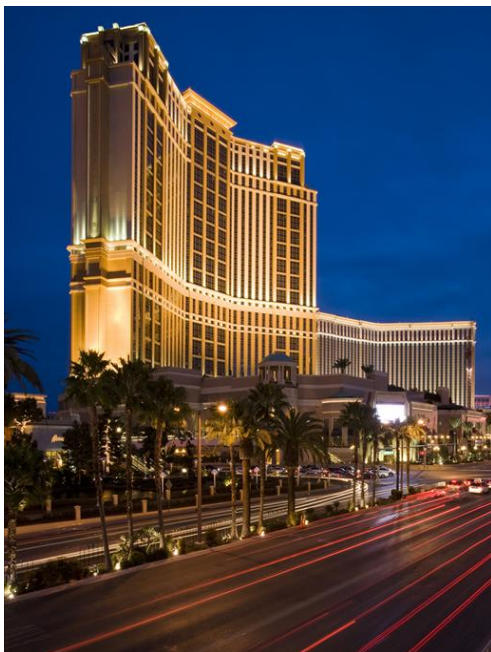

THE PALAZZO RESORT HOTEL AND CASINO

Designers: Joe Kaplan, Martin van Koolbergen,
Kristy Benner

Company: Kaplan Gehring McCarroll
Architectural Lighting, Inc.

Los Angeles Section

2009 AWARD OF MERIT

PROJECT NAME

10 Arts Restaurant at the Ritz Carlton Philadelphia
100 Westminster Street
2000 Avenue of the Stars
2000 Tower Oaks Boulevard
A French-Empire Urban Oasis
Adidas Performance Store
Adventure Science Center: Sky & Space Addition
AIA Chicago Headquarters
Aileron Campus
ALCARE HUKURO HOUSE
Alexandra Arch, Alexandra Road
Alger Middle School
Allen & Jeannette Early Center for Christian Education & Worship
Allsteel and Gunlocke Resource Center Chicago
American Red Cross- Atlanta Campus
Anperena Momochi
AO
AOYAMA OM-SQUARE
AOYAMA OM-SQUARE Tea Ceremony Room
Arizona Research Laboratory Public Spaces
Armstrong Oil & Gas
AT&T Experience Retail Prototype
AtlantiCare Regional Medical Center - Expansion & Renovation
Atlantis, The Palm
Ave Maria Oratory
Avenal Childcare Center
Avenue of the Arts
Bar 360
Barclays Global Investors
BBG-BBGM Empire State Building Office
Beijing Olympic Stadium, Facade Lighting
Bethesda Lane
Bexar County Courthouse
Birmingham Jefferson Convention Complex Concert Hall Renovations
Birnam Wood Residence
Bloorview Kids Rehab
Bonny Slope Elementary
Boston Gallery
Boston Logan 9/11 Memorial
Boston Symphony Hall Clerestory and Statuary Lighting
Brookline Town Hall Renovation
Caesars Palace Beijing Noodle Company No. 9
Carbon Valley Library
Casino of the Winds at Mohegan Sun
Chanel Boutique Beverly Hills

SECTION

San Francisco
Boston
New York City
District of Columbia
Milwaukee
Toronto
New York City
St Louis
New York City
International
International
Grand Rapids
Roanoke
St Louis
Philadelphia
International
International
International
San Francisco
New York City
Los Angeles
Philadelphia
Dallas
District of Columbia
Orange County
Philadelphia
Milwaukee
San Francisco
District of Columbia
International
District of Columbia
Dallas
Birmingham
Santa Barbara
Toronto
Portland, OR
Boston
Boston
Boston
Boston
Los Angeles
Denver
New York City
New York City

PROJECT NAME	SECTION
Chess Club and Scholastic Center of Saint Louis	St Louis
Chicago Cultural Center, Preston Bradley Hall, Dome Renovation	Madison
Chicago Penthouse	Chicago
CHINA BASIN LANDING	San Francisco
Cirque Du Soleil / Criss Angel Sanctuary	Detroit
Co-Cathedral of the Sacred Heart-Exterior Lighting	Los Angeles
COFRA/Good Energies Offices	New York City
Cole Haan Outlet Store Prototype	Los Angeles
Color Kinetics Headquarters	New York City
Commemorating the 50th Anniversary of the Reconstruction of Meiji Jingu "Akarium"	International
Concord Music Group	Los Angeles
Confidential Consulting Firm Office	Boston
Contemporary Mountain Residence	Denver
Core sunlighting demonstration project at the British Columbia Institute of Technology	Vancouver
Corporate Headquarters, Norwalk, CT	New York City
Cosentino's Market Downtown	Kansas City
Coventry Headquarters Phase Three	Los Angeles
Crown Lighting of Blue & Green Diamond Pyramids	Miami
Custom House Tower	Boston
Dalad Group Corporate Office	Cleveland
Dana-Farber/Brigham and Women's Cancer Center at Milford Regional Medical Center	Boston
Department of National Defense Headquarters	Ottawa
Design Duncan Miller Ullmann Offices - Dallas,TX	Dallas
DEX Regional Headquarters	Denver
Dollar Bank/ Cleveland	Cleveland
Donald E. Stephens Convention Center - Porte Cochere "Circle Drive"	Chicago
DTW North Terminal	Detroit
Dynamic Domes	Milwaukee
Eco-Glow	International
Elizabeth Arden, Fifth Avenue, NYC	New York City
Epworth-Euclid United Methodist Church	Cleveland
Erie Canal Harbor	New York City
Fair of Barcelona Gran Via	International
Federal State Parliament, Vaduz, Princedom of Liechtenstein	International
Fifth Third Bank – Fountain Square Facade Renovation	Philadelphia
Formosa Boulevard Station	International
Four Seasons Hotel Vancouver / Yew Restaurant	Vancouver
Gallaudet University James Lee Sorenson Language and Communications Center	Detroit
Garden Illumination, Chinzan-so and Four Seasons Hotel Tokyo at Chinzan-so	International
Gateway Transportation Center	St Louis
George Stanley Fountain at the Hollywood Bowl	Los Angeles
GERSTEIN SCIENCE INFORMATION CENTRE UNIVERSITY of TORONTO	Toronto
Gingko Bacchus Restaurant	International

PROJECT NAME

Ginza Takamoto Building
Gran Tokyo
Grand Canal Square, Dublin, Republic of Ireland
GreenPix - Zero Energy Media Wall
Griffith Observatory Solar Transit Instrument
GSC Group
HanMeiLin Museum, Beijing
Harold Alfond Center for Cancer Care at Maine General
Harrington Raceway and Casino
Harvard Club New York City
Harvard-Westlake School
Harvey Nichols Jakarta
Holy Family Catholic Church
House of Light
Houston Baptist University - The Morris Arts Center (Belin Chapel, Recital Hall & McNair Hall)
Hudson Alpha Institute of Biotechnology
Hyatt San Diego Mural Lighting
Illumination of Historic Tenth Street Bridge
Indiana University Purdue University Campus Center
Indianapolis International Airport Col. H. Weir Cook Terminal
Intelligent Beauty
Intercontinental- The Clement Monterey
Jersey Boys Theatre Lobby
JetBlue Terminal
Kia Headquarters and Design Center - Energy
Kia Headquarters and Design Center - Exteriors
Kia Headquarters and Design Center - Interiors
Kitchen Project, West 67th Street
Kogakuin University Hachioji Campus Student Center
Krischanitz Building Novartis Campus, Basel, Switzerland
L2 Lounge
LAN Club, Beijing
Las Vegas Chamber of Commerce
Layers of Life - Jiuchongjin Show Room, Hefei, China
Lewis & Clark Caverns State Park
Light Spiral
Lighting Design Alliance Design Office
LIV at Fontainebleau
Logan College Student Center
Loma Linda University Cancer Institute
Lone Butte Casino
Lumen United Reform Church and Community Centre
MadHouse
Mahoney Library
Manhattan Residence
Mark Taper Forum

SECTION

International
International
International
New York City
New York City
New York City
International
Boston
Philadelphia
New York City
Los Angeles
Los Angeles
Salt Lake City
International

Chicago
Atlanta
Seattle
Miami
Detroit
St Louis
Los Angeles
San Francisco
Los Angeles
New York City
Los Angeles
Los Angeles
Los Angeles
New York City
International
International
District of Columbia
International
Las Vegas
International
District of Columbia
Toronto
Los Angeles
New York City
St Louis
Orange County
Minneapolis
District of Columbia
Seattle
San Francisco
New York City
Los Angeles

PROJECT NAME

Mark Taper Forum
Martin Olav Sabo Bridge
Mashiki Community Center
Metro Courthouse
MGM Grand Detroit Casino-Hotel and hospitality
MGM Grand Detroit-Casino and Dining
Microsoft Executive Briefing Center Expansion
Middle School, Sidwell Friends School
Mila
MIT Auditorium 10-250
MODEGAKUEN SPIRAL TOWERS
Museum Gunzenhauser, Chemnitz
Museum of Chinese Film
Naach K'inil
National Audio-Visual Conservation Center
National Audubon Society Headquarters
National Palace Museum
Nihon University College of Art Ekoda Campus Students Hall
NIKI CLUB KANKIKAN
NLOP 8300, 8400, 8500 Parking Ramps Relighting
North End Elementary School Access Ramp Lighting
Northstar Preserve
Nota Bene
Novo Nordisk Headquarters, 1100 Campus Dr, Princeton, NJ
Novo Nordisk Product Launch Space
NYC Waterfalls
Oak Court Residence
Oak Room and Oak Bar
Odawa Casino Resort
Ohlone College Newark Center for Health Sciences and Technology
Old Parkland Hospital Renovation and Addition Project
Oldham County Library
Outer Drive East Riviera Club Swimming Pool
Palm Desert Residence
Park Avenue Armory Interim Lighting, NYC
Park Meadows Mall Lifestyle Expansion
Parking lot lighting on 200 Blvd. Bouchard, Dorval, Quebec, Canada
Parliament building, Bern, Switzerland
PepsiCo Sustainability Center
Pere Marquette Lobby
Phillips Academy, Andover Timken Room
Playboy Enterprises, NYC Offices
Plaza Civica
Powerhouse Restaurant and Bar
Private High Rise Residence
Prudential Lobby
Puma City

SECTION

Los Angeles
Tampa
International
Nashville
Detroit
Detroit
Seattle
Los Angeles
Dallas
Boston
International
International
Detroit
Mexico City
San Francisco
New York City
International
International
International
Minneapolis
Minneapolis
Denver
Toronto
Philadelphia
Philadelphia
New York City
Dallas
New York City
Los Angeles
San Francisco
Dallas
Cincinnati/Louisville
Chicago
Milwaukee
New York City
St Louis
Montreal
International
Chicago
Dallas
Boston
New York City
Mexico City
Chicago
Dallas
Boston
New York City

PROJECT NAME	SECTION
puredistance perfume lounge	International
Re/Max Headquarters	Denver
REI Boulder Prototype Store	San Francisco
Restoration of The Benjamin Franklin National Memorial	Boston
Retrofit Of The Savings Bank Berchtesgadener Land	International
Roaring Fork Residence	Denver
Robson Square Renewal Project	Vancouver
Rochester First Street Plaza	Minneapolis
Rock Sugar	New York City
ROCKEFELLER MEMORIAL CHAPEL - University of Chicago	Chicago
Rouge Tomate Restaurant	New York City
Royalton Hotel	New York City
S. Giovanni Cathedral, Tavazzano	International
Sally Hershberger Salon	Los Angeles
Sant Ocean Hall	Boston
Second Home Kitchen and Bar	New York City
SENDAI PARCO	International
Shawnee Mission Medical Center - Critical Care Services Expansion	Kansas City
SHINCRON	International
Shrine Asian Kitchen Lounge and Nightclub at MGM Foxwoods	Boston
Shrine of Our Lady of Guadalupe	District of Columbia
Sky Aquarium with Perrier cafe	International
Sony Wonder Technology Lab	Boston
Spectrum Health, Lemmen-Holton Cancer Pavilion Lobby	Grand Rapids
Spectrum Health, Lemmen-Holton Cancer Pavilion Tunnel	Grand Rapids
St. Anthony Falls Office Building	Minneapolis
St. James' Church	New York City
St. Jerome Catholic Church Oconomowoc, WI	Milwaukee
St. Louis office of Cannon Design	St Louis
Stantec Toronto Office	Toronto
Star city passway lighting installation	International
Stryker Orthopaedics Learning Center	Montclair
Swarovski Ginza, Tokyo Japan	International
Swedish Orthopedic Institute	Seattle
T&T, Luxor Casino	Los Angeles
TAKASAKI MONOLITH	International
Terminal 5, Heathrow Airport, London	International
Terminal B, Pier A: New Retail Concourse and Foodcourt, Logan International Airport	Boston
Terminus 100	New York City
The Biloxi Bay Bridge	New York City
The Bridge Golf Club	New York City
The Canadian National Vimy Memorial	Ottawa
The Cascades Jingumae: Condominium in Tokyo	International
The Christman Building	Detroit
The Dolder Grand Hotel, Zurich, Switzerland	International
The Dubai Aquarium	Atlanta

PROJECT NAME

The Huntington Art Gallery Historic Renovation
The Liberty Hotel
The Martin Woldson Theatre at the Fox
The Metropolitan Museum of Art - The Wrightsman Galleries for French Decorative Arts
The New York Times Building - Facade Lighting
The New York Times Building - Interior Lighting
The Nezu Memorial House
The Peninsula Tokyo
The Regent Bal Harbour
The Samuel Roberts Noble Foundation Administration Building
The Simpsons Ride
The Visionaire/Pool Area: Battery Park City Site 3, New York, NY
The Visionaire: Battery Park City Site 3, New York, NY, Energy
The Visionaire: Battery Park City Site 3, New York, NY, Cutler
"This Way", Brooklyn Bridge Underpass
Thomas Jefferson University - Dorrance H. Hamilton Academic Building
THSR Zuoying Station
Thurston Avenue Bridge over Fall Creek
T-JOY Izumo
TKTS Ticket Booth
Tokyo Waterfront Garden at the Tokyo Towers
Topline Corporation Office Conversion
Turnberry Town Square
U.S. BANK TOWER
Uintah Recreation Center
Unitarian Fellowship of Lawrence
University of Arizona Norton School of Family and Consumer Sciences
University of Colorado Denver Health Sciences Library
University of Illinois Chicago Forum
University of Washington: South Lake Union School of Medicine - Phase II
USA Headquarters
Utah State Capitol Restoration and Renovation
UW Health Radio Therapy Expansion
VA Pittsburgh CARES Consolidation Administration Building, Pittsburgh, PA
Vera Wang New York Flagship Store
Virtual Light Loft
Wasabi Restaurant - Taj Hotel
Watson Divide Residence
Welcome Wall
Westin Galleria - Dallas, TX
WGV Cafeteria, Stuttgart
Williams Sonoma Brand Green Redesign
World Market Center, Building C and Plaza
Yu Garden Residence
Zen Restaurant - Park Hotel

SECTION

Los Angeles
District of Columbia
New York City

San Francisco
New York City
New York City
International
International
Dallas
Oklahoma City
Los Angeles
New York City
New York City
New York City
New York City
Philadelphia
International
Rochester
International
New York City
International
Seattle
Las Vegas
San Francisco
Salt Lake City
Kansas City
Detroit
Denver
St Louis
San Francisco
Chicago
St Louis
Milwaukee
District of Columbia
New York City
New York City
Los Angeles
Denver
Milwaukee
Dallas
International
Los Angeles
Las Vegas
International
Los Angeles

Editor's Note

The list of 2009 IES Illumination Awards Merit recipients published in November issue was incomplete. Omitted recipients follow. The complete list now appears online at www.ies.org. IES regrets the omissions.

INTERNATIONAL SECTION

Commemorating the 50th Anniversary of the Reconstruction of Meiji Jungu "Akarium"
Designers: Kaoru Mende, Kentaro Tanaka, Natsuko Ueda, Tsutomu Nagatsu, Takafumi Kubo
Company: Lighting Planners Associates, Inc.
Owner: Commemorating the 50th Anniversary of the Reconstruction of Meiji Jungu Committee

Gingko Bacchus Restaurant
Designer: Gregor Hoheisel
Company: Graft
Designer: Ricky Lauwis
Company: Zinta
Owner: The Gingko Group

Gran Tokyo
Designer: Yasuyuki Tomita
Company: Tomita Lighting Design Office, Inc.
Architect: Kazunori Yonemori
Company: Nikken Sekkei
Architect: Masao Yonemura
Company: JR East Design Corporation
Owner: JR East Japan Railway Company

Parliament Building
Designers: Christian Vogt, Luciano Marcassa
Company: Vogt & Partner
Owner: Bundesamt für Bauten und Logistik BBL

Shincron
Architects: Michio Koda, Noboru Segal, Tatsuo Ishiguro
Company: Mitsubishi Jisho Sekkei, Inc.
Designer: Hiroyasu Shoji, Akane Kuroda
Company: Lightdesign, Inc.
Owner: Shincron

LOS ANGELES SECTION

Odawa Casino Resort
Designers: M. David McCarroll, Julie Quinnan
Company: Kaplan Gehring McCarroll Architectural Lighting, Inc.

NEW YORK CITY SECTION

Adventure Science Center: Sky & Space Addition
Designers: Susan Brady, Zengwei Fu
Company: SBLD Studio
Owner: Adventure Science Center

NEW YORK CITY SECTION CONTINUED

Aileron Campus

Designers: Richard Renfro, Eileen Pierce, Pum Photojananuwat

Company: Renfro Design Group

Architects: Lee H. Skolnick, Paul Alter, JoAnn Secor, Alethea Cheng, Miguel Cardenas, Joern Truemper, Maja Gilberg, Peter Hyde, Christina Lyons, Shawn Walsh

Company: Lee H. Skolnick Architectural + Design Partners

Owner: Aileron Campus

Armstrong Oil & Gas

Designers: Charles G. Stone II, Margo Wiltshire, Paula Martinez-Nobles, Gilbert Ong

Company: Fisher Marantz Stone, Inc.

Park Avenue Armory Interim Lighting

Designer: Ku'uipo Curry

SAN FRANCISCO SECTION

Mahoney Library

Designers: Jan P. Myer, Robert Garretson, Junette Kushner

Company: O'Mahony & Myer, Inc.

Owner: Santa Rosa Junior College

ST. LOUIS SECTION

Chess Club and Scholastic Center of Saint Louis

Designers: Jamie Deschler, Margaret McDonald, Lisa Schwartzkopf

Company: Arcturis

Owner: Chess Club and Scholastic Center of Saint Louis

University of Illinois Chicago Forum

Designers: P. David Ziolkowski, Tom Kaczkowski

Company: HOK Lighting Group

Owner: University of Illinois at Chicago

TORONTO SECTION

Bloorview Kids Rehab

Designers: Ellen Godson, Kenneth Loach

Company: Lighting Design Solutions/H.H. Angus & Associates

Architect: Terry Montgomery, Chris Klemt

Company: Montgomery Sisam Architects, Inc.

Architect: Chris Fillingham, Jane Wigle

Company: Stantec Architecture Ltd.

Nota Bene

Designer: Suzanne Powadiuk

Company: Suzanne Powadiuk Design

Owner: Nota Bene